

01. Sideward Fine-tuning :Power-on start in the centering.(Be turn Left/Right Fine -tuning in Mode2)
02. Forward/Backward fine-tuning:Power-on start in the middle.
03. Turn Left/Right fine-tuning:Power-on start in centering.(Be Sideward Fly Fine -tuning in Mode2)
04. Throttle show:Power-on start in lowest level.(Left and Right throttle shows at one time)
05. Forward shows:Power-on start in the lowest level.(At the center square)
06. Backward shows:Power-on start in the lowest level.(At the center square)
07. Right sideward fly shows:Power-on start in the lowest level.(At the center square)
08. Left sideward fly shows:Power-on start in the lowest level.(At the center square)
09. Turn left: Pull left function lever to left, it will be higher, than quad copter turn left faster.
10. Turn right: Pull left function lever to right, it will be higher, than quad copter turn right faster.
11. High/Low speed: Press button "A" for seconds to switch between high speed mode or low speed mode. "H" means high speed and "L" means low speed.
12. Power shows:According to the battery's energy for the controller.
13. Default mode when power-on.When change to MODE 2, please keep pressing button "B" to right than return on the power of transmitter, the MODE on LCD displayer will be changed. Same steps to change to MODE 1 again.
14. Signal shows:Normally to full frame.

## READY TO FLY YOUR QUADCOPTER

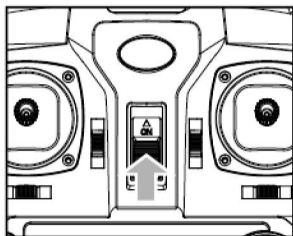

Step 1: 送信機のスイッチを入れる

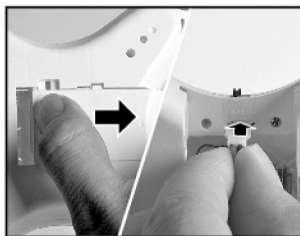

Step2: バッテリーカバーを開けてコネクターを差し込む

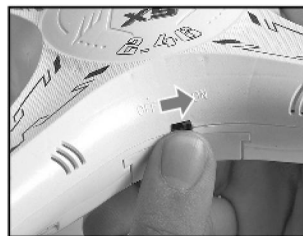

Step 3: 本体のスイッチを入れる

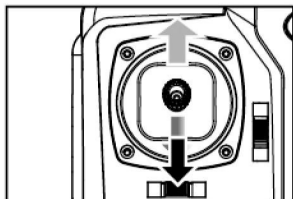

Step 4: スロットルレバーを上いっぱいにして、その後一番下へ戻す。するとはっきりした音が送信機から聞こえる。これでドローンが飛行準備状態になった。接続が確立されると送信機のランプとドローンのランプが点滅から点灯に変わる

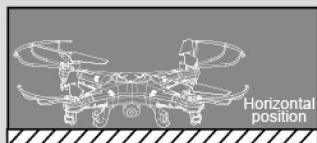

TIPS: 送信機と機体のマッチングが取れると機体は水平状態での安定飛行が出来るようになっている